

ARVEX GROBELNY Sp. z o.o.

ul. Makuszyńskiego 4, 30-969 Krakow, POLAND, EUROPE

INQUIRY

dated 10<sup>th</sup> of June 2022

TOTAL VALUE:

\$0,00

TOTAL WEIGHT:

60 154,80 kg

**Conditions:** CIF Hamburg (shipment from any port)

Quantity to be adjusted to fit into **3 x FCL 20ft** (quantity allowance +/- 10%)

**Payment:** 100% against full set of documents: B/L, Invoice, Packing List, Insurance Policy,  
Certificate of Origin, Fumigation Certificate

**Packaging:** in small boxes, **full bottom boxes**, with Arvex stickers on the smallest side on the front of boxes,  
then in outer carton with Arvex sticker, then on plywood pallet

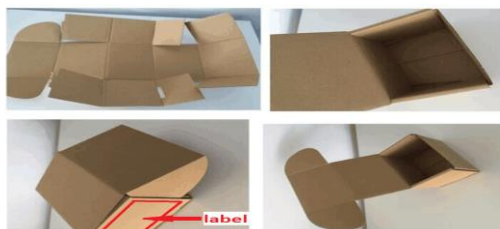

**full bottom boxes**

[ATTENTION - product photos are CLICKABLE - links to website specification](#)

**WGB - Drywall screw, bugle head, phillips recess, **fine** thread, black phosphated**



Arvex reference name	Quantity [pcs]	Price CIF Hamburg [USD/Mpcs]	Value [USD]	Weight [kgs/Mpcs]	Total weight [kgs]	Pcs per box	
WGB 3.5/25	250 000			1,24	310,00	1 000	
WGB 3.5/35	600 000			1,69	1 014,00	1 000	
WGB 3.5/55	150 000			2,50	375,00	500	
		SUBTOTAL:	\$0,00	SUBTOTAL:	1 699,00 kg		

**WGB - Packed in 5 kg small boxes**

Arvex reference name	Quantity [kg]	Price CIF Hamburg [USD/Kg]	Value [USD]	Weight [kgs]	Total weight [kgs]	Kgs per box
WGB 3.5/25 (KG)	2 500			1,00	2 500,00	5
WGB 3.5/35 (KG)	1 500			1,00	1 500,00	5
WGB 3.5/45 (KG)	300			1,00	300,00	5
WGB 3.5/55 (KG)	300			1,00	300,00	5
		SUBTOTAL:	\$0,00	SUBTOTAL:	4 600,00 kg	

TOTAL VALUE:

\$0,00

TOTAL WEIGHT:

60 154,80 kg

**Conditions:** CIF Hamburg (shipment from any port)Quantity to be adjusted to fit into **3 x FCL 20ft** (quantity allowance +/- 10%)**Payment:** 100% against full set of documents: B/L, Invoice, Packing List, Insurance Policy,  
Certificate of Origin, Fumigation Certificate**Packaging:** in small boxes, **full bottom boxes**, with Arvex stickers on the smallest side on the front of boxes,  
then in outer carton with Arvex sticker, then on plywood pallet**WGT** - Drywall screw, bugle head, phillips recess, **coarse** thread, black phosphated

Arvex reference name	Quantity [pcs]	Price CIF Hamburg [USD/Mpcs]	Value [USD]	Weight [kgs/Mpcs]	Total weight [kgs]	Pcs per box
WGT 3.5/25	650 000			1,31	851,50	1 000
WGT 3.5/35	1 100 000			1,71	1 881,00	1 000
WGT 3.5/45	600 000			2,09	1 254,00	1 000
WGT 3.5/55	800 000			2,33	1 864,00	500
WGT 4.2/70	750 000			4,60	3 450,00	500
WGT 4.2/90	200 000			5,55	1 110,00	500
WGT 4.8/120	40 000			9,10	364,00	200
WGT 4.8/160	30 000			14,21	426,30	100
		<b>SUBTOTAL:</b>	<b>\$0,00</b>	<b>SUBTOTAL:</b>	<b>11 200,80 kg</b>	

**WGT** - Packed in 5 kg small boxes

Arvex reference name	Quantity [kg]	Price CIF Hamburg [USD/Kg]	Value [USD]	Weight [kgs]	Total weight [kgs]	Kgs per box
WGT 3.5/25 (KG)	2 500			1,00	2 500,00	5
WGT 3.5/35 (KG)	5 500			1,00	5 500,00	5
WGT 3.5/45 (KG)	8 000			1,00	8 000,00	5
WGT 3.5/55 (KG)	8 000			1,00	8 000,00	5
WGT 4.2/70 (KG)	10 000			1,00	10 000,00	5
WGT 4.2/90 (KG)	2 000			1,00	2 000,00	5
WGT 4.8/090 (KG)	700			1,00	700,00	5
WGT 4.8/100 (KG)	1 000			1,00	1 000,00	5
WGT 4.8/120 (KG)	2 500			1,00	2 500,00	5
WGT 4.8/140 (KG)	1 000			1,00	1 000,00	5
WGT 4.8/160 (KG)	500			1,00	500,00	5
		<b>SUBTOTAL:</b>	<b>\$0,00</b>	<b>SUBTOTAL:</b>	<b>41 700,00 kg</b>	

ARVEX GROBELNY Sp. z o.o.

ul. Makuszyńskiego 4, 30-969 Krakow, POLAND, EUROPE

INQUIRY

dated 10<sup>th</sup> of June 2022

TOTAL VALUE:

\$0,00

TOTAL WEIGHT:

60 154,80 kg

**Conditions:** CIF Hamburg (shipment from any port)

Quantity to be adjusted to fit into **3 x FCL 20ft** (quantity allowance +/- 10%)

**Payment:** 100% against full set of documents: B/L, Invoice, Packing List, Insurance Policy,  
Certificate of Origin, Fumigation Certificate

**Packaging:** in small boxes, **full bottom boxes**, with Arvex stickers on the smallest side on the front of boxes,  
then in outer carton with Arvex sticker, then on plywood pallet

**BKW** - Self-drilling drywall screw, fine thread, bugle head, philips recess, black phosphated



Arvex reference name	Quantity [pcs]	Price CIF Hamburg [USD/Mpcs]	Value [USD]	Weight [kgs/Mpcs]	Total weight [kgs]	Pcs per box
BKW 3.5/25	250 000			1,42	355,00	1 000
		SUBTOTAL:	\$0,00	SUBTOTAL:	355,00 kg	

**BKW** - Packed in 5 kg small boxes

Arvex reference name	Quantity [kg]	Price CIF Hamburg [USD/Kg]	Value [USD]	Weight [kgs]	Total weight [kgs]	Kgs per box
BKW 3.5/35 (KG)	600			1,00	600,00	5
		SUBTOTAL:	\$0,00	SUBTOTAL:	600,00 kg	

TOTAL VALUE:	\$0,00	TOTAL WEIGHT	60 154,80 kg
--------------	--------	--------------	--------------

Anti-Dumping Tax rate	
Additional Tarric code	